

## SCREW COMPACTORS RPS

### Shaftless Screw Compactors

#### MACHINE DESCRIPTION

This unit is a combined machined that allows to perform 3 features at once: draining, conveying and compacting/dewatering. By effectively reducing the volume of the material handled (**up to 50%**). The range of compactors includes several models for different applications.

**R.E.M.** offers the compactor manufactured with a trough conveying section and shaftless screw. The covers are tightly bolted onto the trough and seal the enclosure. Shaftless screw compactor can be used for:

- **MUNICIPAL SCREENINGS.**
- **INDUSTRIAL WASTE (FEATHERS - PAUNCH - ENTRAILS).**

#### WORKING LOGIC FOR SHAFTLESS SCREW COMPACTORS RPS

Compactors are equipped with a loading section where the inlet hopper is located; its dimensions may vary depending on the application. Under the inlet there is an initial draining zone from where the most substantial liquid part of the waste to process comes out.

The screw inside the trough conveys the solid material to a second zone where the machine is equipped with a compacting and unloading module.

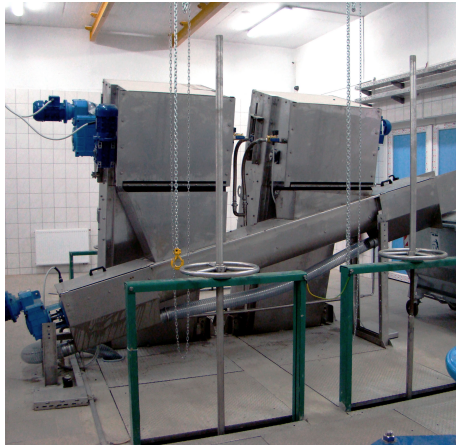

Here a cylindrical sieve allows the material conveyed to be permanently relieved of any remaining liquids. In front of the outlet of the compacting and draining module there is a cover fixed on the top that opens only when sufficient dewatered waste material has accumulated inside the sieve until forming a real plug.

The counterweight increases the level of compaction of the waste, the level is adjustable by moving the weight along the rod.

In addition to the counterweight, as an accessory, these models of compactors are equipped with an extension to increase the pressing.

**R.E.M. RPS compactors** can be equipped with the following accessories:

- **vertical discharge.**
- **bagging (single or endless bag type).**
- **heating and weather protection.**
- **centralized solenoid valves and piping.**
- **control cabinet.**
- **ATEX or UL NEMA 7 EX-proof version.**



#### MAIN ADVANTAGES FOR COMPACTORS RPS

- **No leaks, smells or aerosols generated by the system.**
- **No drives in contact with the sludge.**
- **Compact design and small footprint.**
- **Low operation and maintenance costs.**
- **Low costs for installation and erection.**
- **Conveying and dewatering performed by a single unit.**

STANDARD DIMENSIONAL DATA FOR SHAFTLESS SCREW COMPACTORS RPS

RPS MODELS	A - mm	B - mm	C - mm	CAPACITY - m <sup>3</sup> /h	POWER - kW
RPS200	3010	2000	231	2.0	1.5
RPS300	4400	3000	331	5.0	3.0
RPS400	5819	4000	431	8.0	5.5

n.b.: the manufacturer may modify some dimensions or sizes without prior information

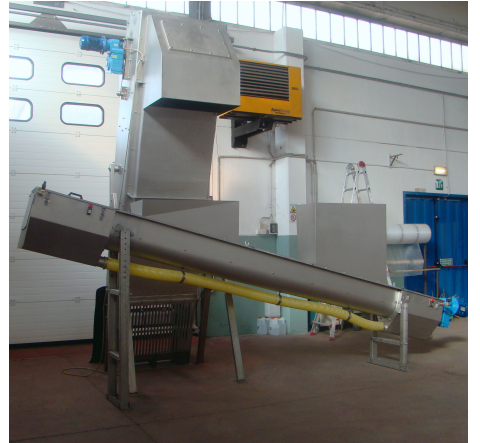
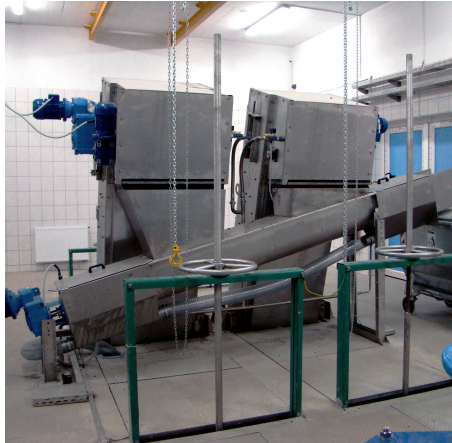

Materials of construction for fabricated parts:  
 \*Stainless Steel AISI304 / \*Stainless Steel AISI316

Materials of construction of spiral: \*Stainless Steel AISI304 / \*Stainless Steel AISI316 / \*High resistance steel HRS

INCLINATION: 5° - 30°

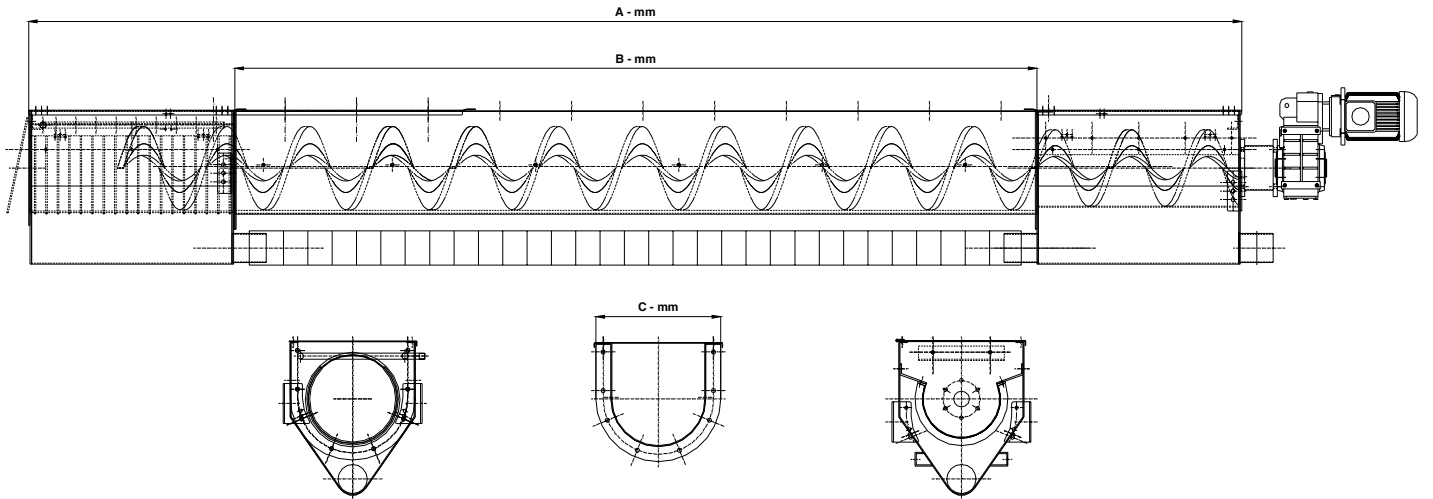

THE PERCENTAGE OF REDUCTION IN THE VOLUME OF WASTE IS GREATER THAN 40%.